

# VANDAL-COMM<sup>®</sup> SPECIFICATION SHEET

A DIVISION OF RADIO SOUND CORP.

RSC  
207 S. Chestnut  
PO Box 252  
Chebanse, IL 60922

## RSC405/XX

In-Line Row Buttons

Vandal/Weather Resistant Entrance Panel

## RSC505/XX

Double-Row Buttons

Vandal/Weather Resistant Entrance Panel

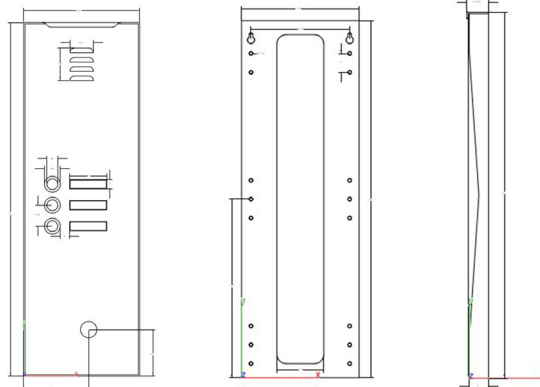

RSC405/3LP-19

### GENERAL DESCRIPTION - All Models

The RSC405/505/XX is a complete vandal resistant entrance panel with integral speaker/microphone and up to 18 push to call buttons. The Panel is constructed of 14 gauge, brushed stainless steel. Individual name holders are included, with optional permanent engraving available upon request.

A microswitch for control of door release devices is optional and accommodates mounting of a postal lock.

Mounting hole size:  $\Phi$ 19mm  
Switch rating: 3A/250VAC  
Switch combination: 1NO  
Operation types: Resettable  
Head shape: Round  
Enclosure material: Nickel plated brass/Stainless steel  
Degree of protection: IP65, IK08

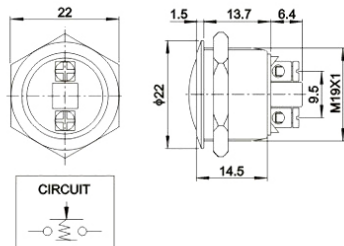

Tail configuration	Wiring terminal
Switch specifications	5A/250VAC
Contact resistance	< 50m $\Omega$
Insulation resistance	> 1000k $\Omega$
Dielectric Intensity	2000VAC
Ambient temperature	-20°C ~ +55°C
Mechanical life	50万次以上 500,000 cycles
Electrical life	5万次以上 50,000 cycles
Panel thickness	1 ~ 10mm
Nut torque	5 ~ 14Nm
Operation pressure	约4N About 4N
Operation stroke	约1.8mm About 1.8mm
Protection level	IP67, IK08
Contact	Silver alloy
Button	Nickel plated brass/stainless steel
Enclosure	Nickel plated brass/stainless steel
Base	PA66

Material



### DIMENSIONS:

#### RSC405/505SLD/SLDP:

WIDTH 4"  
DEPTH 1.125"  
HEIGHT 13"-15"-19"

#### RSC405/505:

WIDTH 6.25"  
DEPTH 1.125"  
HEIGHT 15"

#### RSC405/505LP:

WIDTH 6.25"  
DEPTH 1.125"  
HEIGHT 19"

### RECOMMENDED OPTIONAL COMPONENTS:

#### RSC-WH WEATHER HOOD:

WIDTH 6.25"

#### RSC-WHS WEATHER HOOD:

WIDTH 4"

### Speaker Requirements:

Attribute	Value
1.1 Rate power	0.5W
1.2 Max power	1W
1.3 Sensitivity	90 $\pm$ 3dB(AT 0.1M/0.1W, AT 0.6,0.8,1.0,1.2KHZ)
1.4 Impedance	45 $\Omega$ $\pm$ 15%
1.5 Frequency	Fo ~ ~5KHZ
1.6 Resonance frequency	450 $\pm$ 20%
1.7 Distortion rate	$\leq$ 5%
1.8 Magnet size	$\Phi$ 32*18*6
1.9 Weight	50g $\pm$ 8%
2.0 Size	66*66*19Hmm
2.1 voice coil & Material	$\Phi$ 13.28mm Paper
2.2 Cone	Waterproof